

Installation / Installation

Model/Modelo
M420

Pressure Balance Tub & Shower

Rough-In Valve

Robinetterie brute à pression équilibrée pour
baignoire et douche

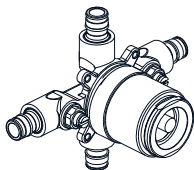

M420CEPX

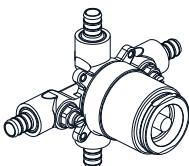

M420PEX

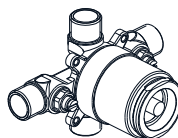

M420

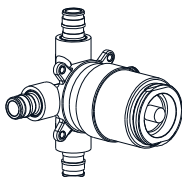

M420CEPX-LS

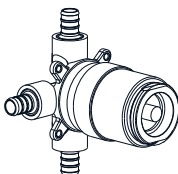

M420PEX-LS

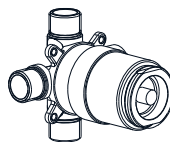

M420-LS

Tools You Will Need / Outils dont vous aurez besoin



Adjustable Wrench
Clé à molette



Pipe Tape
Ruban pour tuyau



Groove Joint Pliers
Pince multiprise



Phillips Screwdriver
Tournevis cruciforme



Cold Expansion Tools

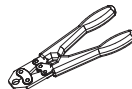

Crimping Tool

INSTALLATION TIPS

- The manufacturer suggests using a locally licensed plumber for installation.
- Do not use PEX for tub spout drop.
- If you use soldering for the installation of the faucet, the seats, cartridges and washers will have to be removed before using flame. Otherwise, warranty will be void on those parts.

CONSIGNES DE INSTALLATION

- Le fabricant suggère de confier l'installation à un plombier qualifié pour exercer dans cette région.
- N'utilisez PEX pour raccorder le bec.
- Si vous posez le robinet par brasage, il est essentiel de retirer les sièges, les cartouches et les rondelles avant d'appliquer la flamme, faute de quoi la garantie sur ces pièces sera annulée.



Installation / Installation

Model/Modelo
M420



M420CEPX



M420PEX



M420

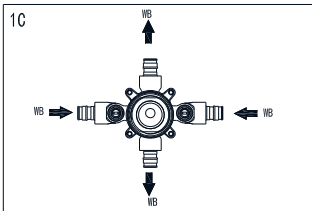
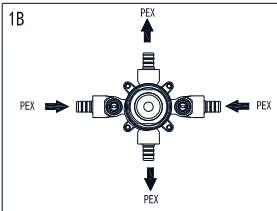
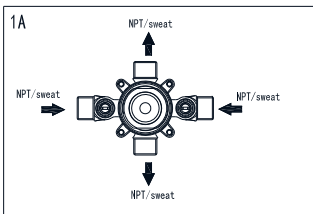

M420CEPX-LS



M410PEX-LS



M420-LS

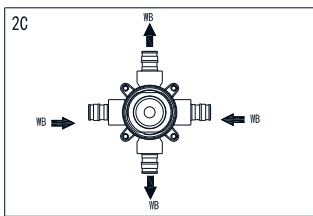
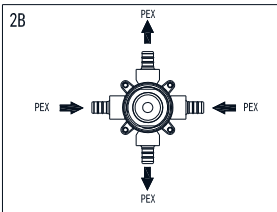
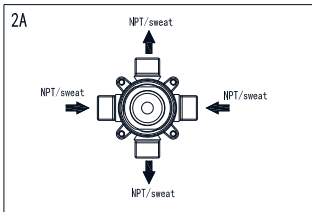

Installation / Installation

Model/Modelle
M420

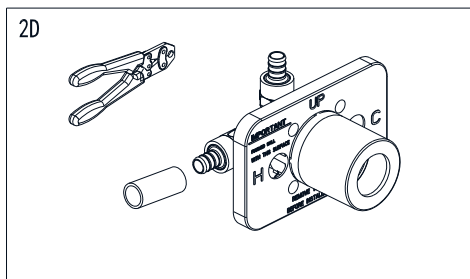
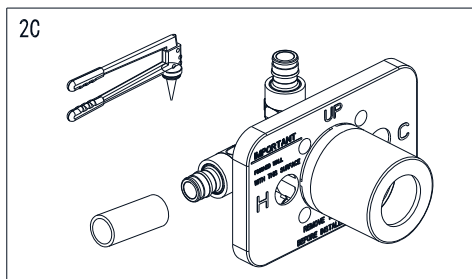
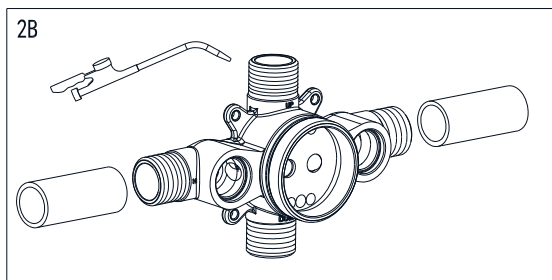
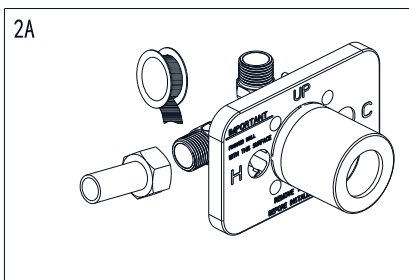
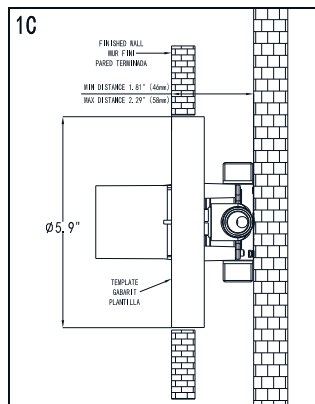
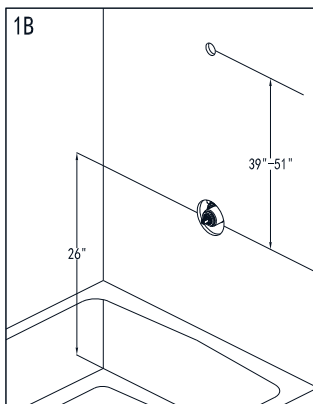
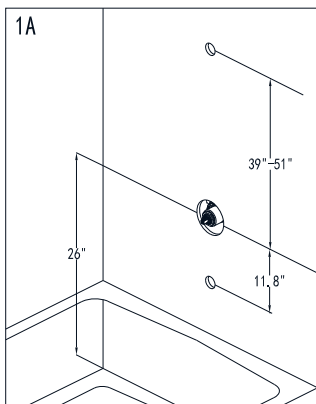

Installation / Installation

Model/Modelo
M420

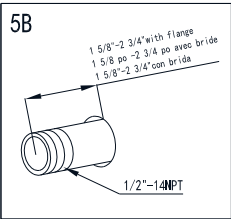
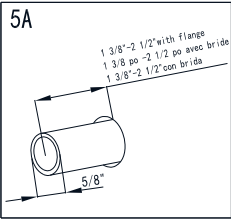
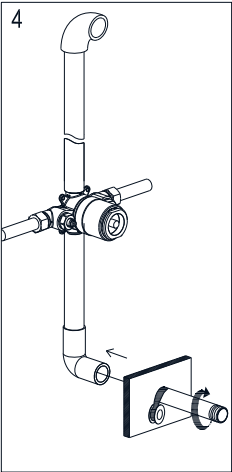
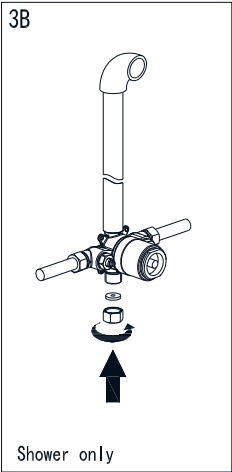
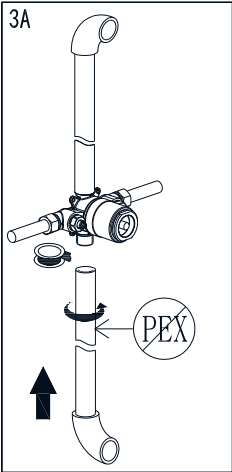

Installation / Installation

Model/Modelo
M420

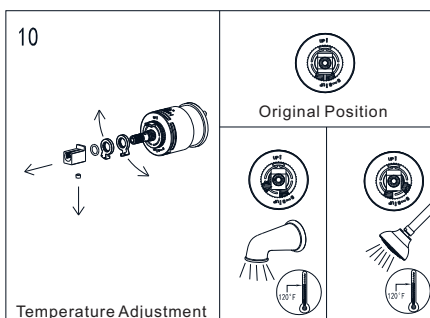
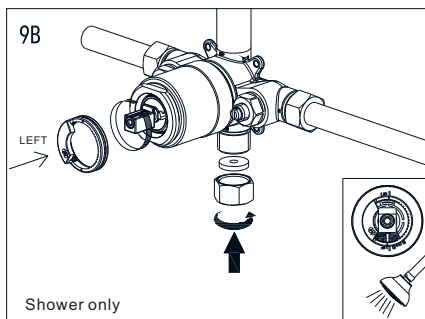
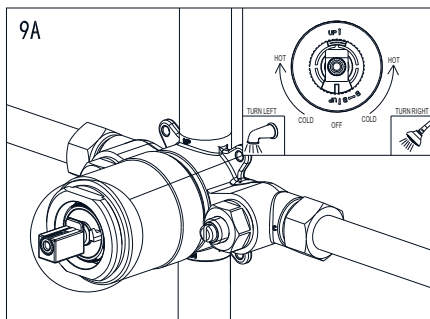
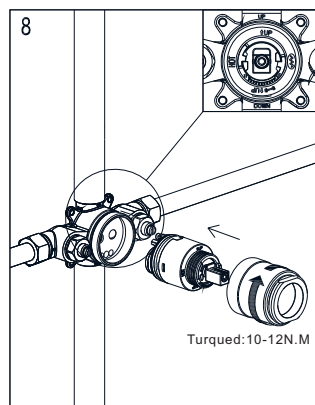
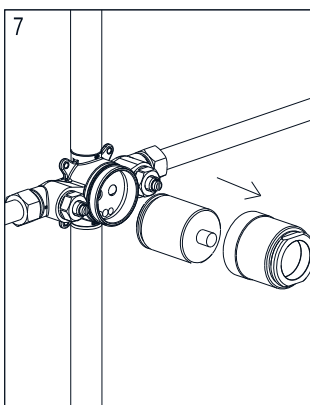
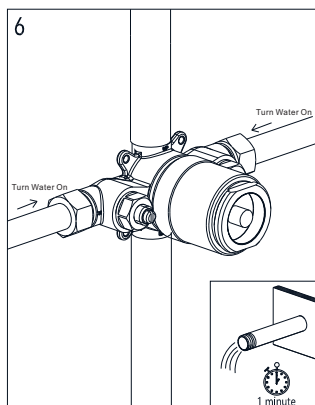

11A

BLACK TO BACK INSTALLATION

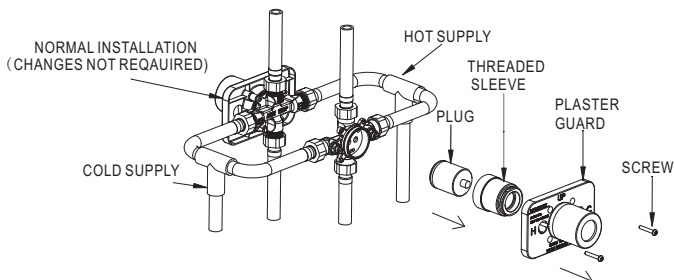

1. Remove the screw, the plaster guard, the threaded sleeve and the plug.

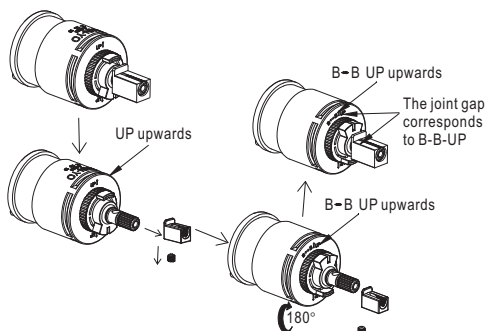

2. Remove the joints and screws from the normally installed cartridge, then rotate the cartridge 180 degrees so that the B-B side faces upward before reinstalling. Ensure that the joint is securely locked with a screw.

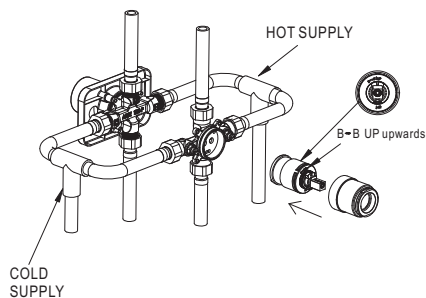

3. Install the modified cartridge onto the body, ensuring that the B-B orientation is facing upwards. Secure the cartridge in place using the cartridge locking sleeve.

11B

BLACK TO BACK INSTALLATION

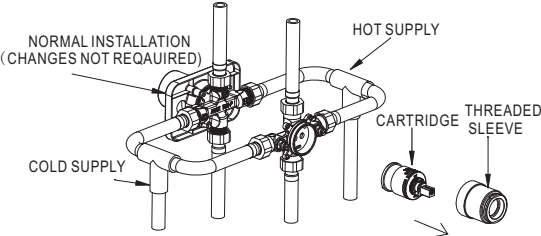

1.Remove the threaded sleeve and the cartridge

2.Remove the joints and screws from the normally installed cartridge,then rotate the cartridge 180 degrees so that the B-B side faces upward before reinstalling. Ensure that the joint is securely locked with a screw.

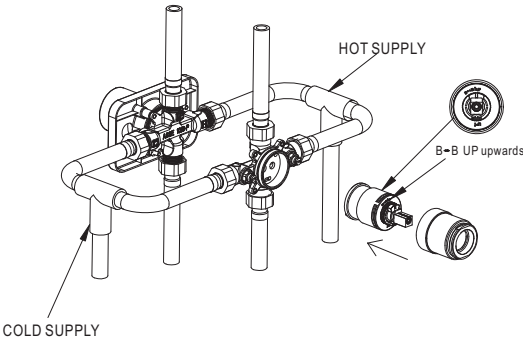
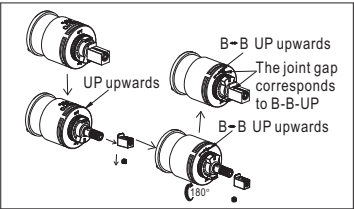

3.Install the modified cartridge onto the body, ensuring that the B-B orientation is facing upwards. Secure the cartridge in place using the cartridge locking sleeve.



Replacement Parts / Pieces de rechange

No.	Description	Part No.
1	Lock Screw	CTST0182
2	Plaster Guard	CTCP0361
3	Adapter	CTMP0059
4	Threaded Sleeve	CTCT0185
5	Plug	CTCP0688
6	O-ring	CTRR0266
7	Checkstop	ATBD0165
8	O-ring	CTRR0163
9	Body	CTYB0870
10	Washer	CTWR0088
11	Plug	CTTB0038

* please indicate finish for these parts

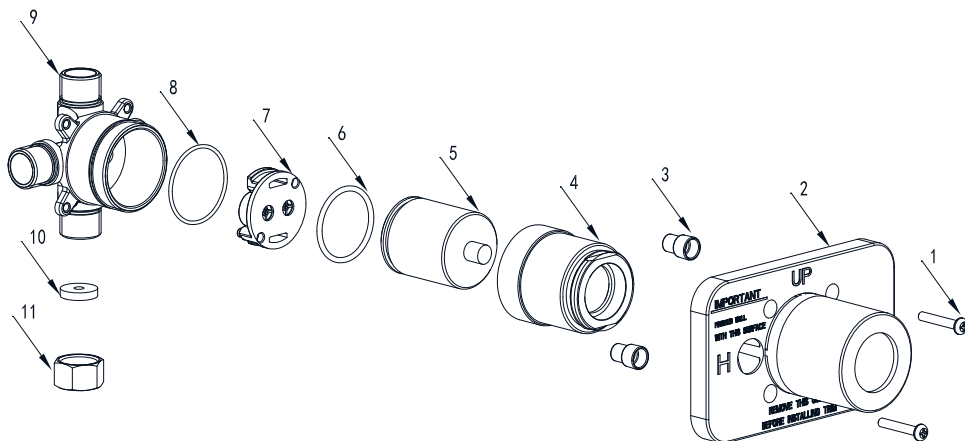

Replacement Parts / Pieces de rechange

No.	Description	Part No.
1	Lock Screw	CTST1005
2	Plaster Guard	CTCP0704
3	Threaded Sleeve	CTCZ0232
4	Plug	CTCP0688
5	Checkstop	ATBY0370
6	Spring	CTBT0123
7	Checkstop	ATBA0435
8	Body	ATBY0381
9	O-ring	CTRR0204
10	O-ring	CTRR0266

* please indicate finish for these parts

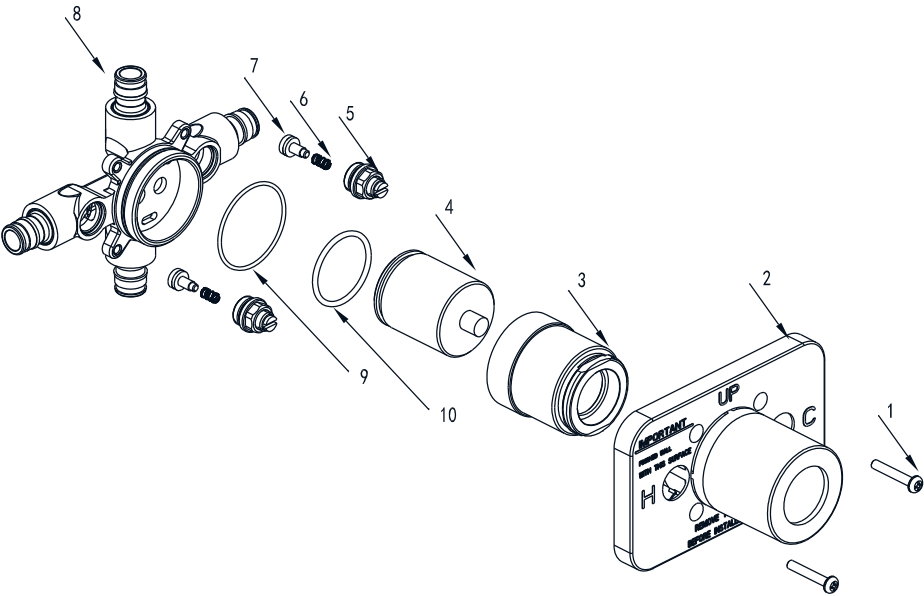

Replacement Parts / Pieces de rechange

No.	Description	Part No.
1	Lock Screw	CTST1005
2	Plaster Guard	CTCP0704
3	Threaded Sleeve	CTCZ0232
4	Plug	CTCP0688
5	Checkstop	ATBY0370
6	Spring	CTBT0123
7	Checkstop	ATBA0435
8	Body	ATBY0380
9	O-ring	CTRR0204
10	O-ring	CTRR0266

* please indicate finish for these parts

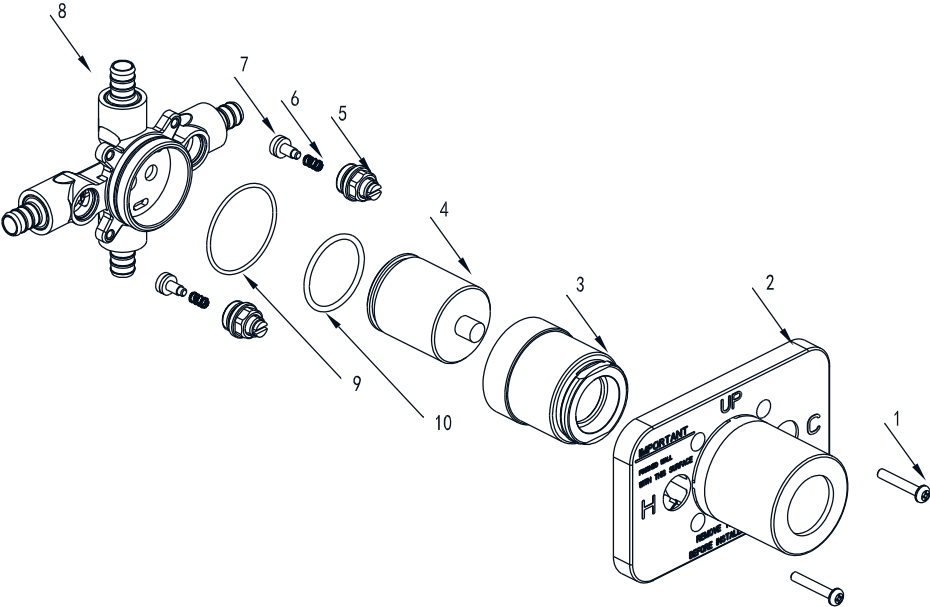

Replacement Parts / Pieces de rechange

No.	Description	Part No.
1	Lock Screw	CTST1005
2	Plaster Guard	CTCP0704
3	Threaded Sleeve	CTCZ0232
4	Plug	CTCP0688
5	Checkstop	ATBY0370
6	Spring	CTBT0123
7	Checkstop	ATBA0435
8	Body	CTYB0869
9	Washer	CTWR0088
10	Plug	CTTB0038
11	O-ring	CTRR0204
12	O-ring	CTRR0266

* please indicate finish for these parts

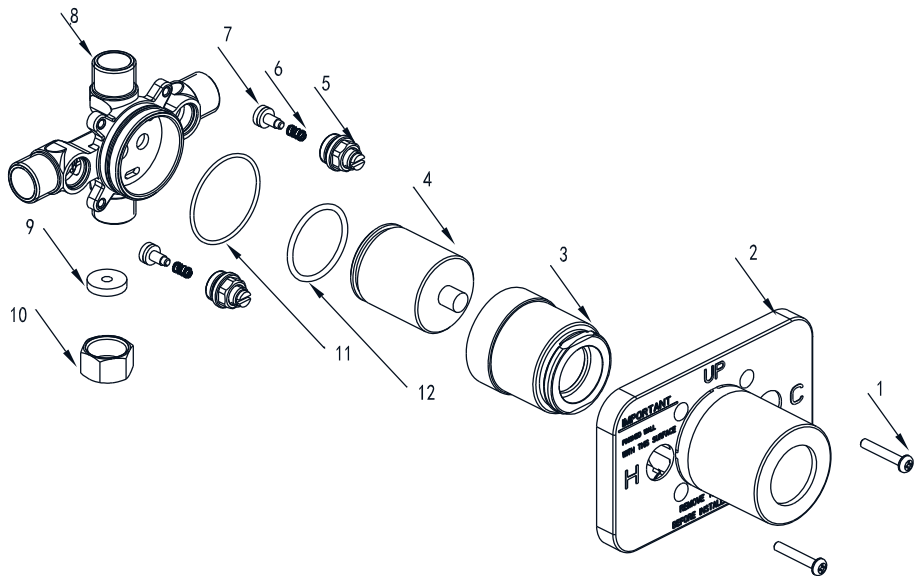

Replacement Parts / Pieces de rechange

No.	Description	Part No.
1	Lock Screw	CTST0182
2	Plaster Guard	CTCP0361
3	Adapter	CTMP0059
4	Threaded Sleeve	CTCT0185
5	Plug	CTCP0688
6	O-ring	CTRR0266
7	Checkstop	ATBD0165
8	O-ring	CTRR0163
9	Body	ATBY0384

* please indicate finish for these parts

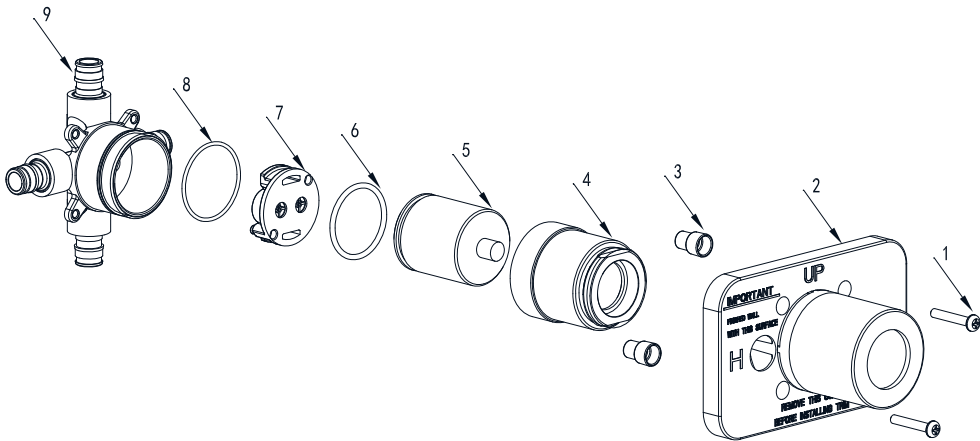

Replacement Parts / Pieces de rechange

No.	Description	Part No.
1	Lock Screw	CTST0182
2	Plaster Guard	CTCP0361
3	Adapter	CTMP0059
4	Threaded Sleeve	CTCT0185
5	Plug	CTCP0688
6	O-ring	CTRR0266
7	Checkstop	ATBD0165
8	O-ring	CTRR0163
9	Body	ATBY0383

* please indicate finish for these parts

