



# MAINLINE®

Preferred by the pros.™

# LI<sup>N</sup>EA

## 10" Shower Arm & Flange

### SPECIFICATIONS



LN10CMSA





#### Features

- 10" Shower Arm for Ceiling Mount Application
- Finished Metal Body
- W/ Square Flange
- 1/2" -14 NPT Connection – Ceiling Side
- 1/2" – 14 NPSM Connection – Shower Side



#### Kit Components

- Square Shower Flange – MLSSF
- 10" Shower Arm – ML10CMSA

#### Standards & Certifications

			
	✓		

#### Available Finishes

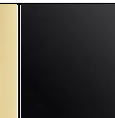
			
✓	✓		✓

Specified model meets or exceeds the following:

- ASME A112.18.1/CSA B125.1
- IAPMO/cUPC

#### AVAILABLE FORMATS

Multiple Kit Formats Available  
Visit [mainlinecollection.ca](http://mainlinecollection.ca)

Mainline products have been manufactured under the highest standards of quality and workmanship. That is why we offer "Limited 5 Year" warranty on the function and finish of our accessories.



Please visit [www.mainlinecollection.ca](http://www.mainlinecollection.ca) for available finishes. Finish is defined by additional suffix.

#### Drawings

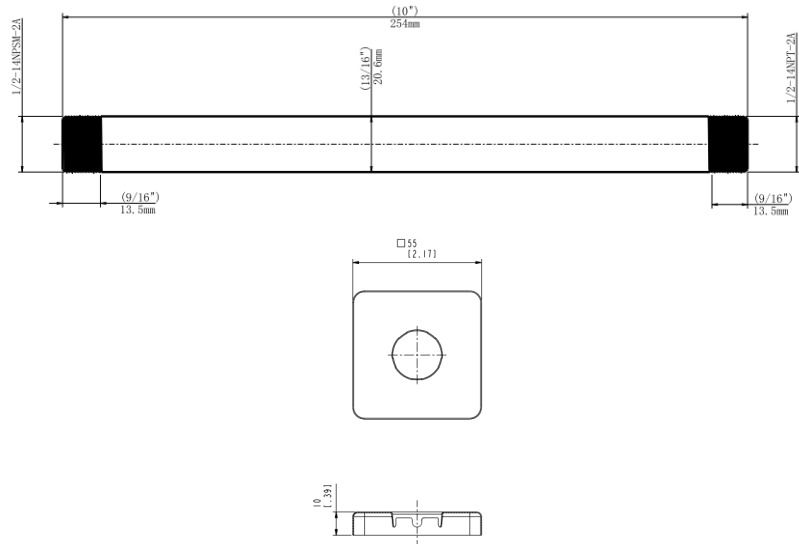

### SUBMITTAL INFORMATION

Name: \_\_\_\_\_ Contractor: \_\_\_\_\_  
Location: \_\_\_\_\_ Contact #: \_\_\_\_\_  
Notes: \_\_\_\_\_

#### Service & Parts

Please reach out to [epleservice@emcoltd.com](mailto:epleservice@emcoltd.com) for support/ visit [mainlinecollection.ca](http://mainlinecollection.ca) / CANADA +1 (450) 621 5636